

# PRODUCT PAGE

For technical and availability information,  
please contact Onmar.

+46 (0) 16 42 86 80

info@onmar.com

www.onmar.com



## STALON SCUPPER

Stainless Steel 316 Face & Nylon 66 +  
30% Fiberglass Filled Body

- Combining the strength and light weight of a reinforced nylon with the aesthetics of polished stainless steel.
- Tested according to ASTM D638 and ASTM D790.
- One-way PVC flapper for discharge and reducing backwash.

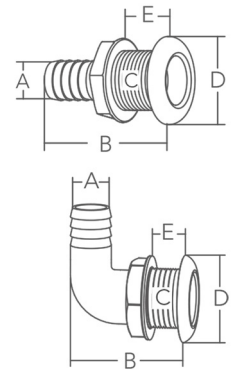

Part number	Angle	A (mm)	B	C	D	E (max mm)
M7-10-9005253	0°	38	121	56	83	45
M7-10-9005254	0°	52	121	56	83	45
M7-10-9005241	10°	38	86	56	83	20
M7-10-9305461	15°	38	166	56	83	83
M7-10-9005260	90°	38	109	56	83	20